

CONFIDENTIAL: This document/program, including the content, is property of Emerson Process Management and must be held in strict confidence and properly safeguarded by the recipient at all times. It may not be copied or reproduced, or provided or revealed to any other part, except with prior authorization of an appropriate officer of Emerson Process Management and any authorized copy or reproduction must include this admonition. The recipient may use the same only for the purpose for which Emerson Process Management has provided it to the recipient. The document must be returned to Emerson Process Management upon request. By accepting this document/program, the recipient agrees to the foregoing.

ALL DIMENSIONS REFERENCE

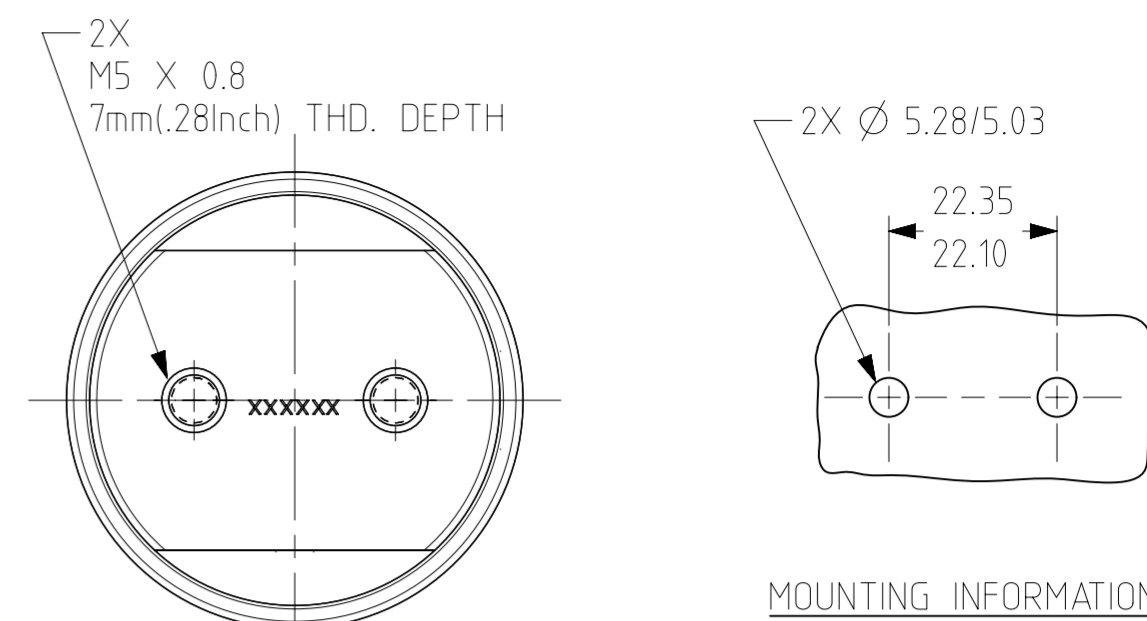
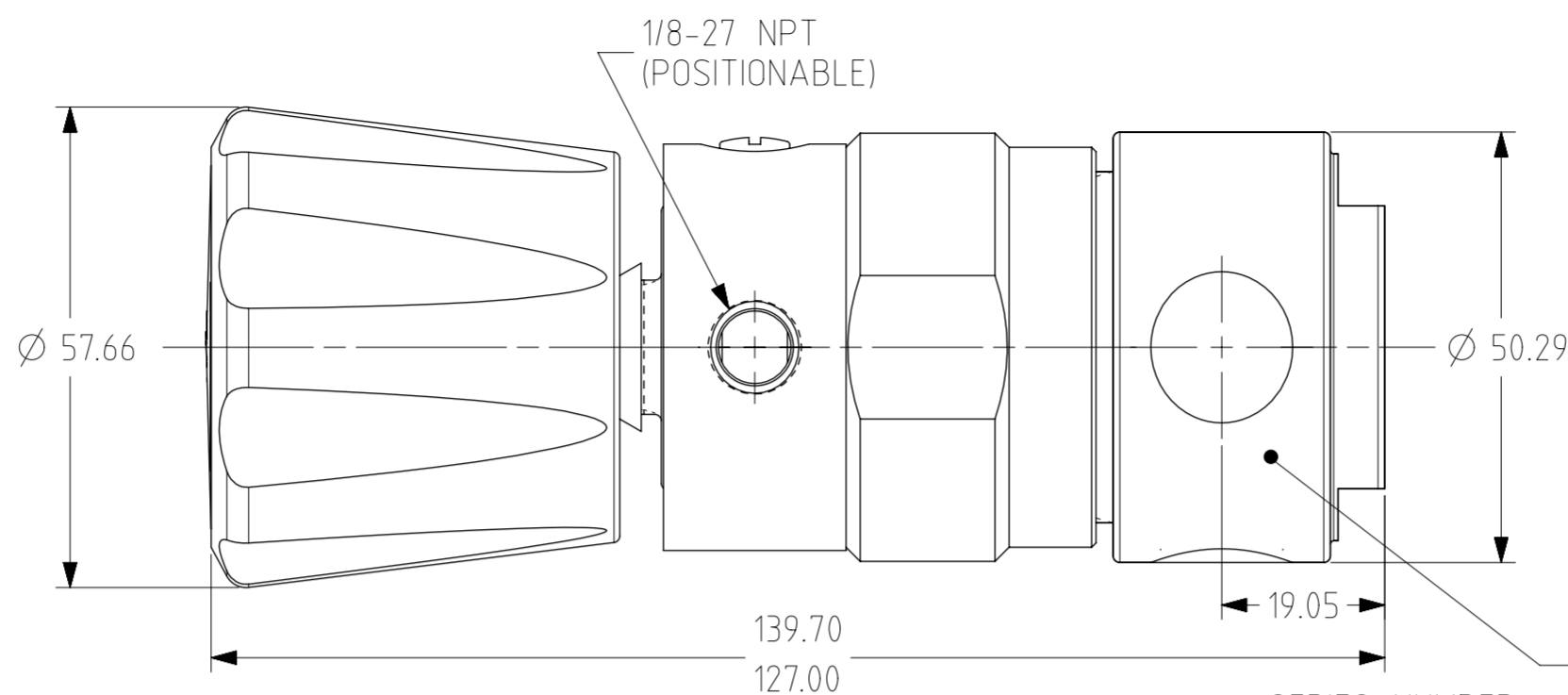
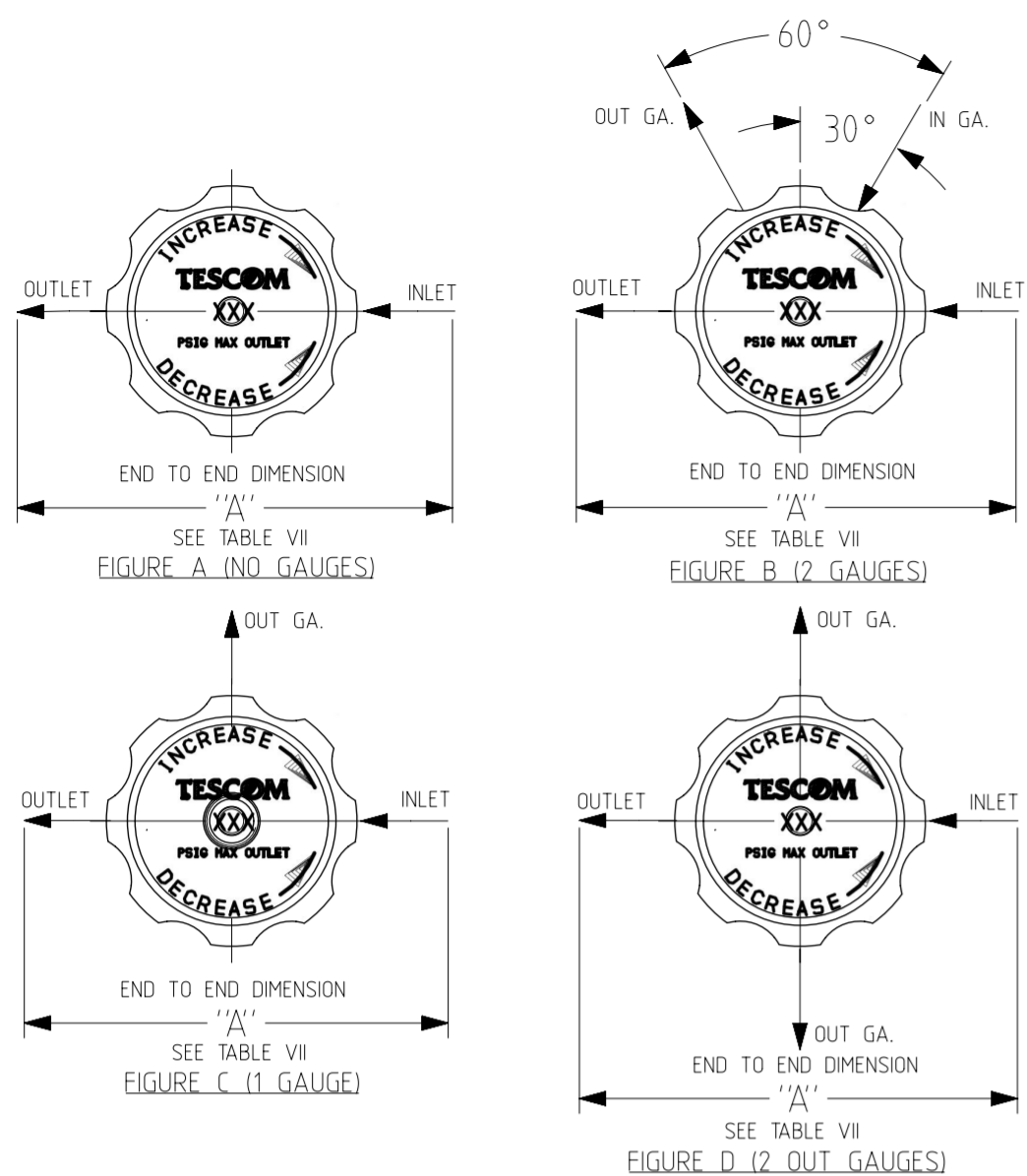

64-2800 SERIES REGULATOR

SPRING LOADED, HAND OPERATED, POSITIVE SEAL DESIGN, PRESSURE REDUCING REGULATOR WITH METAL TO METAL SEALED DIAPHRAGM, 0.2 Ra MICROMETER FINISH ON ALL WETTED SURFACES.

GENERAL SPECIFICATIONS:

INLET PRESSURE: SEE TABLE VI  
 OUTLET PRESSURE: SEE TABLE II  
 DESIGN PROOF PRESSURE: 150% OF RATED PRESSURE  
 DESIGN BURST PRESSURE: 400% OF RATED PRESSURE  
 OPERATING TEMPERATURE: SEE TABLE III  
 LEAKAGE: INTERNAL: BUBBLE TIGHT  
 EXTERNAL:  $<1 \times 10^{-9}$  atm cc/sec. PER ASTM E449  
 FLOW CAPACITY (Cv): SEE TABLE VI  
 WEIGHT: APPROXIMATELY 2 LBS.

MATERIALS CONTACTING LINE MEDIA:

SEAT: SEE TABLE III  
 BODY: SEE TABLE I  
 DIAPHRAGM: SEE TABLE VI  
 REMAINING PARTS: SEE TABLE VI

ASSEMBLY INFORMATION:

FOR ASSEMBLY OF THIS UNIT USE SPEC:  
 A41271-01 -- 64-28XXXXX1X 64-28XXXXX4X  
 A41271-02 -- 64-28XXXXX2X 64-28XXXXX3X

KITS:

NONMETALLIC: (64-28XXKXX1X) (64-28XXKXX4X)  
 NONE AVAILABLE NONE AVAILABLE  
 (64-28XXKXX2X) (64-28XXKXX3X)  
 NONE AVAILABLE NONE AVAILABLE

REPAIR:

(64-28XXKXX1X) (64-28XXKXX4X)  
 389-3631 NONE AVAILABLE  
 (64-28XXKXX2X) (64-28XXKXX3X)  
 389-3632

SERIES NUMBER  
 64-2861KR922

DASH NO.	BODY MATERIAL	FINISHING
6	316L SST VAR	ELECTROPOLISH PER SEMI F19 HP GRADE
4	316L SST	ELECTROPOLISH PER ASTM B 912

DASH NO.	OUTLET PRESSURE
0	0-30 PSI
1	0-60 PSI
2	0-100 PSI
3	0-150 PSI

DASH NO.	SEAT MATERIAL	OPERATING TEMPERATURE
K	PCTFE	-40°F TO +140°F
V	VESPEL	-40°F TO +350°F

DASH NO.	IN & OUT PORT TYPE	COMPATIBLE WITH:
A	HPIC	VCR/VACUSEAL
H	WELDED HI-FLOW	VCR/VACUSEAL
R	WELDED	VCR/VACUSEAL
T	WELDED	- - - - -

DASH NO./LTR	INLET & OUTLET PORT SIZE	"A" ± 0.06(Inch)	
		HPIC	WELD-TUBE
4	1/4	- - -	3.00
6	3/8	- - -	3.00
8	1/2	- - -	3.00
G	1/4 MALE, SWIVEL	- - -	4.50
H	1/4 FEMALE, SWIVEL	- - -	4.50
K	1/2 MALE, SWIVEL	- - -	4.75
L	1/2 FEMALE, SWIVEL	- - -	4.75
A	1/4 FIXED, MALE	- - -	3.51
N	IN PORT: 1/4 MALE, SWIVEL OUT PORT: 1/4 FEMALE	- - -	4.50
Q	1/4 FEMALE, SWIVEL	- - -	4.29
R	IN PORT: 1/4 FEMALE OUT PORT: 1/4 MALE SWIVEL	- - -	4.50
M	1/4 MALE, SWIVEL	- - -	3.70
P	1/4 MALE, SWIVEL	- - -	5.34
T	1/4 FEMALE, SWIVEL	- - -	3.70
U	IN PORT: 1/4 MALE(SHORT NUT) OUT PORT: 1/4 FEMALE SWIVEL	- - -	3.70
B	1/4 FIXED, MALE	- - -	3.38
9	1/4 MALE, SWIVEL	- - -	4.65
C	1/4 FIXED, MALE	- - -	4.08
V	IN PORT: 1/4 FEMALE SWIVEL OUT PORT: 1/4 MALE(SHARP NUT)	- - -	3.70

GAUGE PORT OPTION			
DASH NO.		NUMBER OF GAUGE PORTS	GAUGE PORT LOCATION
0	NONE	0	SEE FIGURE A
1	1/4 HPIC-A	1	SEE FIGURE C
2	1/4 HPIC-A	2	SEE FIGURE B
3	1/4 HPIC-A	2	SEE FIGURE D
4	1/4 MALE, SWIVEL	2	SEE FIGURE D
5	1/4 MALE, SWIVEL	1	SEE FIGURE C
6	1/4 MALE, SWIVEL	2	SEE FIGURE B
7	1/4 FEMALE, SWIVEL	2	SEE FIGURE D
8	1/4 FEMALE, SWIVEL	1	SEE FIGURE C
9	1/4 FEMALE, SWIVEL	2	SEE FIGURE B
N	1/4 TUBE STUB	2	SEE FIGURE B
P	1/4 TUBE STUB	1	SEE FIGURE C
R	1/4 TUBE STUB	2	SEE FIGURE D
S	1/4 FIXED, MALE	2	SEE FIGURE B
T	1/4 FIXED, MALE	1	SEE FIGURE C
U	1/4 FIXED, MALE	2	SEE FIGURE D
V	1/4 MALE, SWIVEL @ 12 O'CLOCK 1/4 FEMALE, SWIVEL @ 6 O'CLOCK	2	SEE FIGURE D

DASH NO.	MAX. INLET PRESSURE	DIAPHRAGM MATERIAL	WETTED PARTS MATL.	FLOW CAPACITY
1	3500 PSI	316L SST	316 SST	Cv = 0.06
2	1000 PSI	316L SST	316 SST	Cv = 0.15
3	1000 PSI	HASTELLOY	316 SST/3	Cv = 0.15
4	3500 PSI	HASTELLOY	316 SST/3	Cv = 0.06

SCD: REFER TO SOURCE CONTROL TABLE CATALOG PRODUCTS

NOTES:

1. REGULATOR INCORPORATES AN ADJUSTABLE STOP WHICH ALLOWS THE MAXIMUM OUTLET PRESSURE TO BE LIMITED TO ANY VALUE BETWEEN THE MAXIMUM RATED VALUE AND 50% OF THE MAXIMUM RATED VALUE.

2. VCR, REGISTERED TRADEMARKS OF SWAGelok CO.  
 VACUSEAL, REGISTERED TRADEMARK OF PARKER HANNIFIN IN CORP.  
 MATERIAL TO BE HASTELLOY OR EQUIVALENT PER ASTM B 574.



UNLESS OTHERWISE SPECIFIED TOLERANCE: ± 0.25 ANGLES: ± 1° SURFACE FINISH: 2.5 Ra BREAK SHARP CORNERS: 0.5 MAX DO NOT SCALE THIS DWG		 © 1996 2015 UNITS: MILLIMETERS ASME Y14.5M	INSTALLATION INFORMATION		
REVISION	ECRN NO 50717-15 CHANGES - APV BY wrbock 04-Jun-2015		PROJECT: DWN niki.qi 02-May-2013 CHK nina.xu 06-May-2013 APV	SHEET: 1 OF 1	SCALE: 1:1
REDRAWN AND CONVERTED FROM INCH TO METRIC		DRAWING		REV	
		64-28XXXXXX		BR	